

CROSS STITCH CHARTS PENGUIN PYRAMID

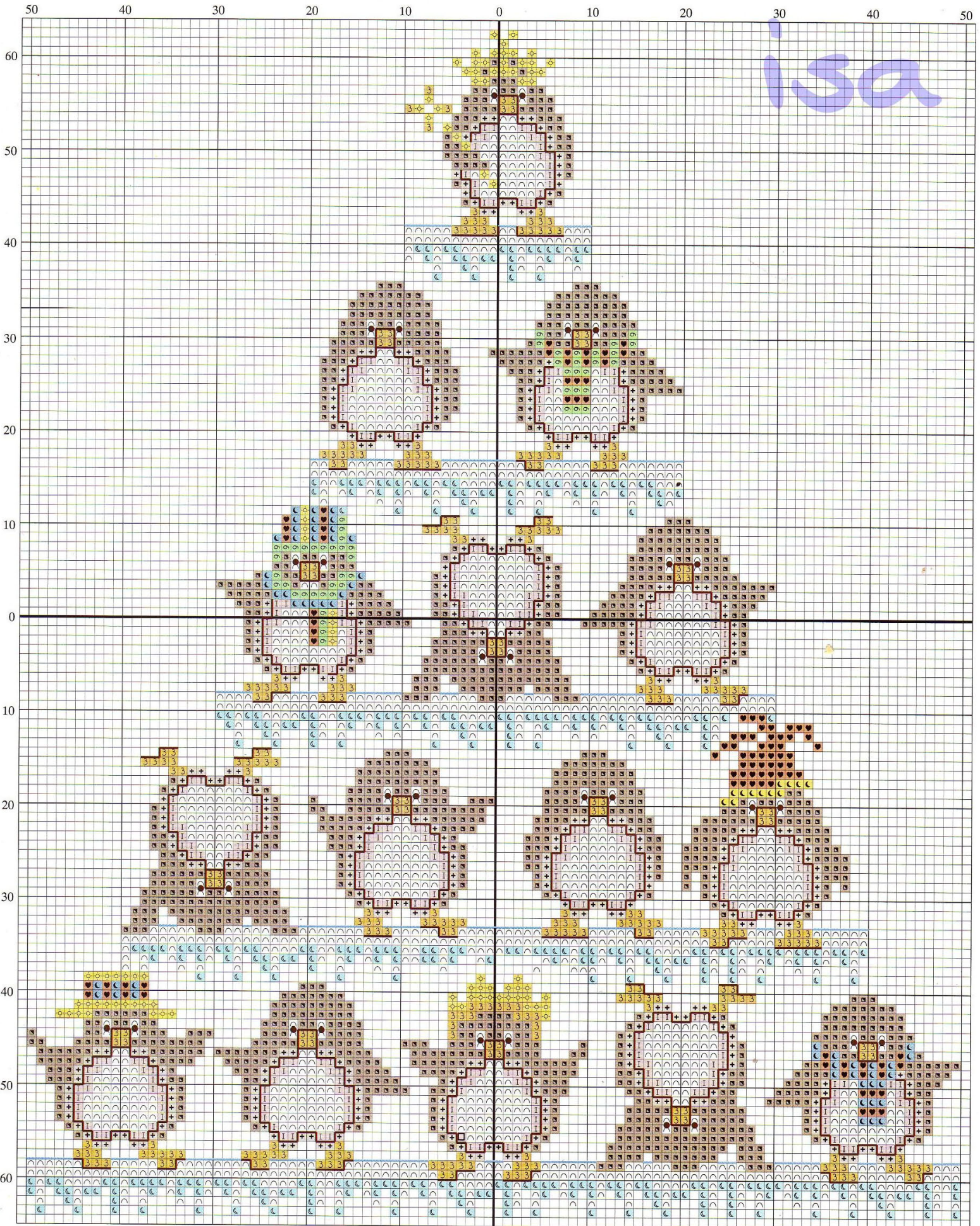

Time-saving IDEA

If you like this design but don't have time to stitch it all, pick out two or three of the penguins and stitch them on separate pieces of sky blue Jobelan. Mount them individually in their own frames and hang them together to create a group of matching pictures.

► SHOPPING LIST PENGUIN PYRAMID

Fabric	28-count light blue Jobelan (NJ429.21 – contact <i>Fabric Flair</i> on ☎ 0800 716 851 for stockists details), measuring 39.5x30.5cm (15½x12in)
Threads	stranded cotton as listed on the key
Needle size	size 26 tapestry
TOTAL COST	excluding frame £10

Knot a PROBLEM

The eyes of these cheeky penguins have been stitched using French knots. If you usually find this stitch a problem, turn to our helpful guide on page 88. You can substitute seed beads for French knots to add another dimension to your stitching if you like.

Stitching TIP

Always remember to wash your hands before stitching. This is especially important when stitching on light coloured fabric as it can soon become a grubby as you stitch.

► KEY PENGUIN PYRAMID

DMC	Anchor	Madeira			
► Cross stitch in two strands					
blanc	1	2401		∩ ∩	white
310	403	2400		■ ■	black
413	401	1713		+ +	grey
666	46	0210		♥ ♥	red
702	226	1306		∞ ∞	green
742	303	0201		3 3	orange
818	23	0502		I I	pink
973	291	0106		⊖ ⊖	yellow
995	410	1102		☾ ☾	dark blue
996	433	1103		☾ ☾	blue
► Backstitch in one strand					
310	403	2400		—	black
996	433	1103		—	blue
► French knots in two strands					
310	403	2400		● ●	black
► Stitch count 127 high x 100 wide					
► Design area 14 HPI (28 HPI) – 22.7x17.9cm (9x7¼in)					
18 HPI – 17.6x13.9cm (7x5½in)					
22 HPI – 14.4x11.4cm (6x4½in)					
This design was stitched using DMC stranded cotton					